

! Attention: Please read the operating manual prior to operating the machine for the first time.

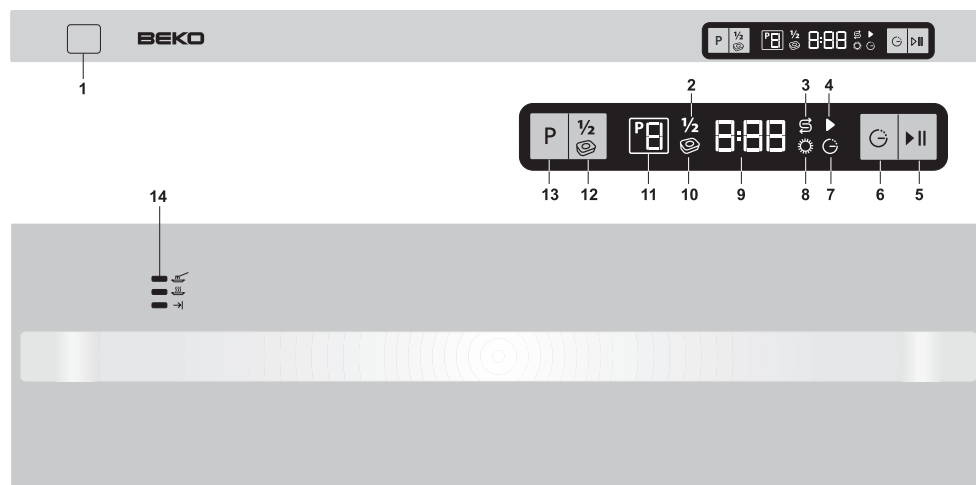

- 1 On/Off button
- 2 Half Load indicator
- 3 Salt indicator
- 4 Start/Cancel indicator
- 5 Start/Cancel button
- 6 Time Delay button
- 7 Time Delay indicator
- 8 Rinse aid level indicator light
- 9 Remaining Time Indicator/ Delay Time Indicator
- 10 Combi Tablet indicator
- 11 Programme indicator
- 12 Half Load/Combi Tablet button
- 13 Programme selection button
- 14 LED progress indicator lights

How to use your dishwasher:

- Open the water tap.
- Plug to the mains.
- Open the door and load the dishwasher. Check if both upper and lower spray arms move freely.
- Pour (Put in) the detergent.
- Push in the on/off button and check that the display lights comes on. Check the salt and rinse aid level indicators before you start the machine. If necessary add salt and rinse aid.
- Use the programme selection button to choose your washing programme.
- You may use Half Load/Combi Tablet button - Delayed Start Button features as necessary.
- Start the programme with the Start / Cancel button:
- Close the door then programme starts.

Attention

Avoid opening the door during the washing process. This interrupts the washing process, and hot steam will escape. When the door is closed, the programme will continue.

- When the program you have selected comes to an end, an audible warning signal with intervals of 8 seconds will warn you to turn off your machine. This audible signal will warn you 10 times before it turns off. Open the door Press the on/off button after the programme is completed. The indicator lights will go off.
- Close the water tap. Pull out the plug.
- Leave your dishes in the machine for about 15 minutes after they are washed in order to have them cooled down. Your dishes will dry in a shorter time if you leave the door of your machine ajar during this period. This will increase the drying effectiveness of your machine.

Programme Table

Programme number	1	2	3	4 Reference*	5 ****	6	7	8
Programme name	Pre-wash	Mini 30'	Delicate	eco	Quick & Clean	Intensive	Baby Protect	Auto
Cleaning temperature	-	35°C	40°C	50°C	60°C	70°C	70°C	40°C - 65°C
Degree of Soiling	Suitable for removing the remnants on the soiled dishes that will be kept waiting in the machine for a few days, and thus, for preventing the bad odor buildup.	Suitable for lightly soiled daily dishes that are scraped or pre-cleaned.	Suitable for dishes that are not pre-cleaned but washed immediately.	Most economical washing program for the medium soiled daily dishes that are kept waiting.	Daily washing program at which the medium soiled dishes that are kept waiting are cleaned in the fastest way.	Suitable for heavily soiled dishes, pots and pans.	Suitable for the dishes which require extra hygiene such as articles for babies. Also suitable for heavily soiled dishes.	Determines the soiling degree of the dishes and sets the temperature and amount of the washing water as well as the washing time automatically. Suitable for all types of dishes.
Detergents A=25 cm³/15 cm³ B=5 cm³	-	A	A	A+B	A+B	A+B	A+B	A
Programme sequence (without options)	Pre-wash ▼ End	Wash ▼ Cold rinse ▼ Hot Rinse ▼ End	Pre-wash ▼ Wash ▼ Cold rinse ▼ Hot Rinse ▼ Dry ▼ End	Pre-wash ▼ Wash ▼ Cold rinse ▼ Hot Rinse ▼ Dry ▼ End	Wash ▼ Cold rinse ▼ Hot Rinse ▼ Dry ▼ End	Pre-wash ▼ Wash ▼ Cold rinse ▼ Hot Rinse ▼ Dry ▼ End	Pre-wash ▼ Wash ▼ Cold rinse ▼ Hot Rinse ▼ Hot Rinse ▼ Dry ▼ End	The programme sequence is adjusted to the amount of soiling
Duration (min)	15	30	83	178	58	143	124	85-179
Water (l)	4	10,4	13,4	13	10,2	16,2	17,8	10,8-14,8
Energy (kWh)	-	0,8	0,88	0,97	1,32	1,26	1,97	0,90-1,50

The consumption values shown in the table were determined under standard conditions. Differences may therefore occur under practical conditions.

* Reference programme for testing institutes The tests in accordance with EN 50242 must be carried out with a full water softener salt dispenser and a full rinse aid reservoir, and using the test programme.

**** It should be tested under a load of 12 place setting. Consumption values are measured under a standard load of 12 place setting.

On/off button

You turn your dishwasher on / off with this button. When turning on, the indicator light for the last used programme will light up.

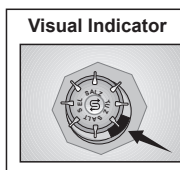

Salt level indicator light

When this indicator light comes on, you must refill special salt (If applicable).

In machines which do not possess an electrical salt indicator, the salt content can be read on the container for the salt. When the visual fill indicator is dark, there is enough salt in the container.

When the colour is light, open the container and add dishwasher salt.

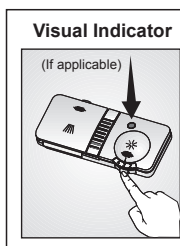

Rinse aid level indicator light

If this indicator light comes on, you have to refill rinse aid (If applicable).

You can also tell whether rinse aid must be refilled by looking at the rinse aid dispenser. When the visual fill indicator is dark, there is enough rinse aid in the dispenser.

When the colour is light, open the dispenser and refill rinse aid.

Program selection buttons

Use the program selection button to select the desired program. The corresponding program light lights up.

Half Load / Tablet Detergent Key

Half Load / Tablet Detergent Key allows you to turn on and off the Half Load and Tablet Detergent functions of your machine.

Half Load Function

If you want to run your machine without loading it completely, place your dishes into the machine as you desire. Press On / Off key to turn on your machine. Press the Half Load / Tablet Detergent key after selecting the desired programme until Half Load Indicator lights up, then press Start / Pause / Cancel key and close the door of your machine. With the Half Load option you can use every part of your lower and upper baskets and you can save from both water and power.

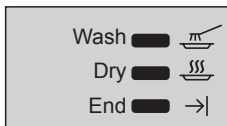

LED progress indicator lights

The program sequence throughout the washing process can be monitored from the progress indicator lights on the control panel.

Warning

Following the washing stage, in order to drain and remove water from inside the machine completely, the machine will pause for approximately 35 minutes. Do not worry this is not a fault. Then End progress indicator light will come on.

Warning

Do not switch the machine off before End light comes on.

Tablet Detergent Function

Depending on the hardness level of the tap water, the Tablet Detergent function allows obtaining a better drying performance from the multi-purpose detergents such as 2in1, 3in1, 4in1, 5in1, etc., called as all-in-one detergents. Tablet Detergent Indicator lights when the Tablet Detergent function is selected. Salt and Rinse Aid indicators turn off when this function is activated.

Turn on your machine by pressing the On / Off key to use the Tablet Detergent function. Press the Half Load / Tablet Detergent key after selecting the desired programme until Half Load Indicator lights up, then press Start / Pause / Cancel key and close the door of your machine.

To use the Half Load and Tablet Detergent functions concurrently, turn on your machine by pressing the On / Off key and then press the Half Load / Tablet Detergent key until Half Load and Tablet Detergent Indicators illuminate together.

Warning If you have used the Half Load or Tablet Detergent features during the last programme you used, Half Load or the Tablet Detergent function will remain active in the next washing programme you will select. If you do not want to use these functions in the new programme you have selected, press

the Half Load / Tablet Detergent key until the indicator of the relevant function turns off.

Changing Warning Sound Volume

Press and hold Half Load / Tablet Detergent key for 5 seconds until S:03 appears on the display. Every time you press the Half Load / Tablet Detergent key, the warning sound level will change as -- Off, S:01 Low, S:02 Medium, and S:03 High. Turn off your machine using the On / Off key to save it. Factory setting of your machine is S:03.

Time Delay

Using the Time Delay key, you may delay the starting time of your programme up to 9.5 hours with increments of 30 minutes. Press Start / Pause / Cancel key after setting the Time Delay and close the door of your machine. Once the time delay is over, the selected programme will start automatically.

Start / Pause / Cancel Key

When you press the Start / Pause / Cancel key, the washing programme you have selected will start. (Start / Pause / Cancel indicator lights in Start mode, and turns off in Pause mode)

Warning To press the Start / Pause / Cancel key, wait for two seconds after you turn on the machine by pressing the On / Off key.

Canceling a programme

Press and hold Start / Pause / Cancel key for 3 seconds. Release the key as the Start / Pause / Cancel indicator starts flashing. Once you close the door of your machine, draining is completed in 2 minutes and the machine gives an audible warning when it is completed.

Warning There might be residues of detergent or rinse aid left in the machine and / or on the pieces being washed depending on the step the programme you have cancelled was in.

Changing a Programme

To change your selection after the programme has started:

1. Press Start / Pause / Cancel key to switch your machine in pause mode.
2. Select the desired programme by pressing the Programme Selection key.
3. Start the new programme by pressing Start / Pause / Cancel key again.

Information The new programme will start from the step where the previous one has stopped. For example, if the previous programme has remained in drying step, new one will start from the drying step as well.

Information If you want to run the new programme from the very beginning, first you must cancel the current programme and then select a new programme.

Improper Loading Of Dishware

