

**! Attention:** Please read the operating manual prior to operating the machine for the first time.



- 1 On/Off button
- 2 On/Off indicator light
- 3 Programme selection Knob
- 4 Start/Cancel button
- 5 LED progress indicator lights
- 6 Salt level indicator light
- 7 Half Load (1/2)

## How to use your dishwasher:



- Open the water tap.
- Plug to the mains.
- Open the door and load the dishwasher. Check if both upper and lower spray arms move freely.
- Fill enough detergent into the detergent dispenser and close the door.
- Use the on / off button to turn the machine on.
- Check the salt and rinse aid level indicator lights. If necessary, refill salt and/or rinse aid.
- Use the program selection Knob to choose your washing program.
- Start the program with the Start/Cancel button:

### Attention

Avoid opening the door during the washing process. This interrupts the washing process, and hot steam will escape. When the door is closed, the programme will continue.

- Use the On / Off button to turn the machine off again. When the progress indicator light "programme end" lights up, the programme is complete.
- Close the water tap. Pull out the plug.
- Allow your dishes to cool for 15 minutes, with the door open. Unload the dishes. Begin with the lower basket.

**Programme Table**

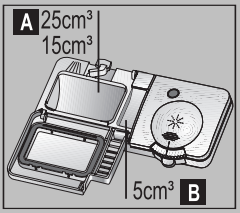
Programme number	1	2 Reference*	3	4
Programme name	 <b>Pre-wash</b>	<b>eco</b>	 <b>Quick &amp; Clean</b>	 <b>Intensive</b>
Cleaning temperature	-	<b>50°C</b>	<b>60°C</b>	<b>70°C</b>
Degree of Soiling	Suitable for removing the remnants on the soiled dishes that will be kept waiting in the machine for a few days, and thus, for preventing the bad odor buildup. 	Most economical washing program for the medium soiled daily dishes that are kept waiting.	Daily washing program at which the medium soiled dishes that are kept waiting are cleaned in the fastest way.	Suitable for heavily soiled dishes, pots and pans.
Detergents A=25 cm³/15 cm³ B=5 cm³	-	<b>A+B</b>	<b>A+B</b>	<b>A+B</b>
Programme sequence (without options)	Pre-wash ▼ End	Pre-wash ▼ Wash ▼ Cold rinse ▼ Hot Rinse ▼ Dry ▼ End	Wash ▼ Cold rinse ▼ Hot Rinse ▼ Dry ▼ End	Pre-wash ▼ Wash ▼ Cold rinse ▼ Hot Rinse ▼ Dry ▼ End
Duration (min)	14	146	58	115
Water (l)	4,2	15	11,8	17,5
Energy (kWh)	-	1,09	1,32	1,67

The consumption values shown in the table were determined under standard conditions. Differences may therefore occur under practical conditions.

\* Reference programme for testing institutes The tests in accordance with EN 50242 must be carried out with a full water softener salt dispenser and a full rinse aid reservoir, and using the test programme.

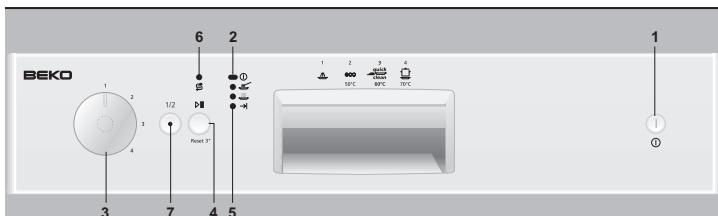

- 1 On/Off button
- 2 On/Off indicator light
- 3 Programme selection Knob
- 4 Start/Cancel button
- 5 LED progress indicator lights
- 6 Salt level indicator light
- 7 Half Load (1/2)

## On/off button

Push in the on/off button and check that the indicator light comes on.

## Visual Indicator



## Salt level indicator light

When this indicator light comes on, you must refill special salt (If applicable).

In machines which do not possess an electrical salt indicator, the salt content can be read on the container for the salt. When the visual fill indicator is dark, there is enough salt in the container.

When the colour is light, open the container and add dishwasher salt.

## Visual Indicator

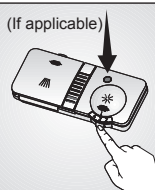

## Rinse aid level indicator light

If the indicator light comes on, you have to refill rinse aid (If applicable).

You can also tell whether rinse aid must be refilled by looking at the rinse aid dispenser. When the visual fill indicator is dark, there is enough rinse aid in the dispenser.

When the colour is light, open the dispenser and refill rinse aid.

## Program selection Knob

Use the program selection Knob to choose your washing program.

## Half Load (1/2) button

When there are few dishes, you press this button after pressing the programme selection button. When turning the dishwasher on, the indicator light on the button lights up. This function helps you to save water and energy.

## Start/Cancel button

You use the button to start the selected program; the light on the button lights up. Stop the program with the Start / Cancel button if you would like to open the door once the dishwasher's washing program is running.

- On/Off ● ①
- Wash ● ②
- Dry ● ③
- End ● →

## LED progress indicator lights

The program sequence throughout the washing process can be monitored from the progress indicator lights on the control panel.

## ! Warning

Following the washing stage, in order to drain and remove water from inside the machine completely, the machine will cancel for approximately 35 minutes. Do not worry this is not a fault. The End progress indicator light will come on when finished.

## ! Warning

Do not switch the machine off before End light comes on.

## How to cancel the washing program

To cancel a program while the machine is operating: Press start/stop button for 3 seconds. The machine will drain the water inside the machine for 45 seconds. The program is cancelled when washing light goes off. Then, you can choose and start a new program.

**! Important:** Depending on the stage of the program you have cancelled, there may be detergent residue or rinse aid inside the machine and on the load. Make sure the items in the dishwasher are not used before washing properly.

## How to change the washing program

To change the program selection while the machine is operating: Press Start/Cancel button. The washing light will go off. Select the new program. Press Start/Cancel button. The washing light will be on and new program will start.

**! Important:** The new program will NOT start from the beginning. It will start from the stage last carried out by the previous program selection.

## Improper Loading Of Dishware

