

BEKO

BKK 2155

Hand Blender

User's Manual



This product has been produced in environmentally friendly, modern facilities

Dear customer,

We would like our product, which is manufactured in modern facilities and which has been subject to detailed quality control process, to provide you with the highest productivity. **Therefore, we would like you to read this manual thoroughly before you start using the product and we would like you to keep it as a reference.**

BEKO

C O N T E N T S



Part 1: Safety Warnings / 3



Part 4: Maintenance and Cleaning / 8



Part 2: Technical Aspects of your machine / 4



Part 3: Using your machine / 5-7

Part 1: Safety Warnings

When using electrical appliances, in order to reduce the risk of fire, electric shock, and/or injury to persons, basic safety precautions should always be followed, including the following:

- Read all instructions carefully, even if you are familiar with the appliance.
- To protect against the risk of electric shock DO NOT IMMERSE the appliance, Cordset or Plug in water or other liquid.
- To clean, wipe exterior with a damp cloth.
- Close supervision is necessary when any appliance is used by or near children. Never leave an appliance unattended when in use.
- Switch off and remove the plug from the power outlet when not in use, before assembling or disassembling parts and before cleaning. To unplug, grasp plug and pull from power outlet. Never pull cord.
- Avoid contacting moving parts. Keep hair, clothing and other utensils away during operation to prevent injury and / or damage to the appliance.

Attention!

Before using the product, read carefully the following operating instructions. It is suggested that you keep these instructions in safe place.

Check whether the voltage indicated on the base of the product is the same as the voltage in your home.

- Do not operate any appliance with a damaged cord or plug, or after the appliance malfunctions or is dropped or damaged in any manner. Return the complete appliance to your nearest authorised service facility for examination, electrical repair, mechanical repair or adjustment.
- The use of attachments or accessories not recommended by this appliance manufacturer, may result in fire, electric shock or personal injury.
- Do not operate when the appliance is empty.
- Do not use outdoors.
- Do not let cord hang over edge of a table, counter, or touch hot surface.
- Do not operate or place any part of this appliance on or near any hot surface (such as a gas or electric burner, or in a heated oven).
- Do not use the appliance for anything other than its intended use.
- Do not abuse the cord. Never carry the appliance by the cord or pull it to disconnect it from the outlet instead, grasp the plug and pull to disconnect.

- When using the extension cord with your appliance make sure the extension cord is correctly wired and rated for its use.
- This product is intended for household use only.
- Do not attempt to repair the appliance yourself; instead, take it your nearest Service Centre or Authorised Service Agent for repair.
- Handle carefully the sharp blades especially during removing and during cleaning.
- This appliance is not intended for use by persons (including children) with reduced physical, sensory or mental capabilities, or lack of experience and knowledge, unless they have been given supervision or instruction concerning use of the appliance by a person responsible for their safety.
- Children should be supervised to ensure that they do not play with the appliance.





Part 2: Technical Aspects of your machine

Voltage / Frequency : 230V ~ 50 Hz.
Power : 400 W Max.
Isolation Class : 
Net weight : 1970 gr.
Dimensions : 170 x 180 x 400 mm.
Capacity of glass bowl : 900 ml.

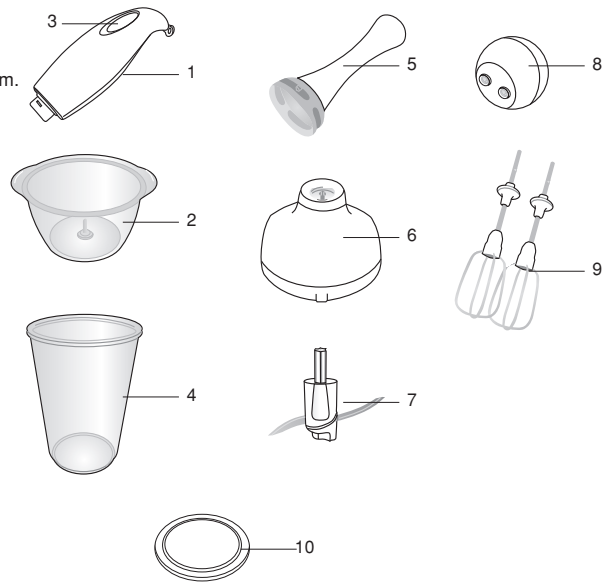

- 1-Motor Body Unit
- 2-Chopping Glass Bowl
- 3-On / Off Button
- 4-Mixing Bowl
- 5-Stainless Steel Blender Attachment
- 6-Chopping Body Unit
- 7-Chopping Blade
- 8-Beater Body Unit
- 9-Beater Attachments
- 10-Non-slip Pad

Part 3: Using your machine

How To Use

Your Hand Blender has been designed for processing small quantities of food and should not be used for any other application. Before first use, wipe of the handle of the blender with a damp cloth. Wash the shaft and blade in warm soapy water. Avoid submerging the appliance part above the shaft. Dry thoroughly.

Using the Blender

The Hand Blender is suitable for making sauces, soups, mayonnaise and baby foods. Insert the blending attachment into the main housing and turn it until it locks in the secured position.

Insert the plug into a standart home power outlet. Place the food to be

blended in a suitable container. Place the blending attachment into the food to be blended and press the on / off button.

Attention!

You can prepare with 380 gr. of carrots and 420 gr. of water during 45 seconds a finely processed "carrot juice".

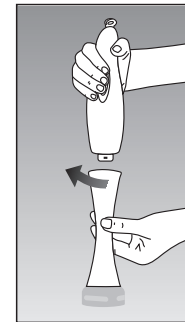

Figure 1

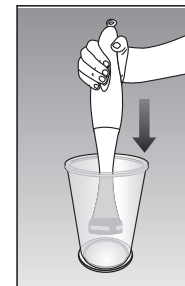

Figure 2



Using the Chopper

Use the chopper for nuts, herbs, boiled eggs, etc. Place the chopping blade and ingredients you wish to chop into the chopping bowl. Put

the chopping body back on and attach the motor body unit to the chopping body unit and screw it into the secured position and plug it. Press the on / off button. Before

removing the processed food, be sure it is unplugged and then take out the blade insert from the chopping bowl.

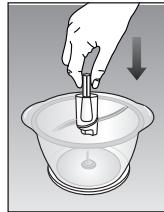

Figure 3

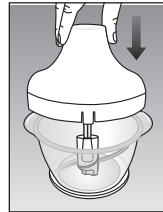

Figure 4a

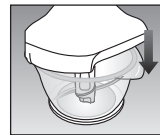

Figure 4b

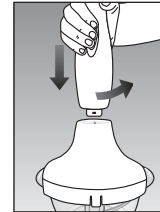

Figure 5

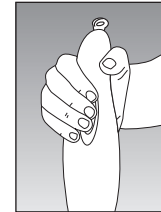

Figure 6

Using the Beaters

Before connecting the beaters onto the motor unit make sure the blender is disconnected from the electrical outlet. Apply the beaters by grasping the top of the blender with one hand and inserting the beater by holding it by its stem with the other hand.

Plug the cord into a standard electrical outlet. Place the ingredients to be mixed in the bowl. Lock the beater attachment onto the beater body and screw the beater body into the motor body unit the secured position. Press the on / off button.

Attention!

Do not operate the appliance continuously more than 10 seconds and when it is empty.

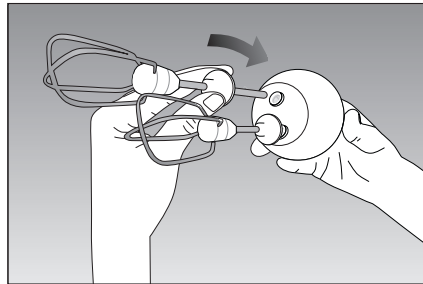

Figure 7

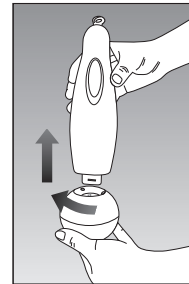

Figure 8

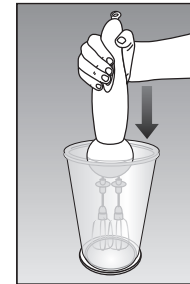

Figure 9



Part 4: Maintenance and Cleaning

Switch off and remove the plug from the power outlet. Immediately after use, wash stainless steel blending attachment. Use only a damp cloth to clean the exterior. Switch off and remove the plug from the power outlet, handle the sharp blade

carefully and store away from children.

Do not let the cord hang over the edge of the tables and work surface or touch hot surfaces.

Attention!
Never immerse the motor base, chopping body and beater body in any liquid.

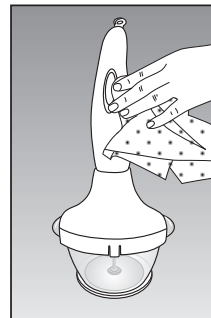

Figure 10